



[FIAT](#) / [PANDA](#) / [1.2 8V](#) / [PROCEDURES](#) / [21 GEARBOX UNIT](#)
 / [2127 ELECTRO-HYDRAULIC SELECTION. GEARBOX EXTERNAL CONTROLS](#) / [2127C HYDRAULIC GEAR SELECTION SYSTEM](#)
 / 2127C52 EVEN AND UNEVEN GEAR ENGAGEMENT SOLENOID VALVES - R.R.

2752683 - 2127C52 EVEN AND UNEVEN GEAR ENGAGEMENT SOLENOID VALVES - R.R.

 Removing ([Refitting](#) )

- [5530B10 battery - r+r](#)
- [5530B56 BATTERY DRIP TRAY COVER - R.R.](#)
- [5530B52 Battery DRIP TRAY/SUPPORT - R.R.](#)
- [2127C40 hydraulic speed selection hydraulic actuator unit and clutch - r r](#)

1. Disconnect the electrical connections (1a) and (1b), undo the bolts (1c) and remove the even and odd gear engagement solenoids (1d).

	Name	Connector
1a	Solenoid 1 gear engagement	L51

	Name	Connector
1b	Solenoid 2 gear engagement	L52

Remove the O-rings from the seats of the even and odd gear engagement solenoids.

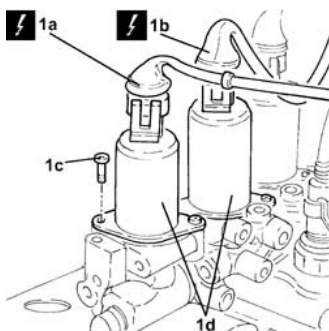

 Refitting ([Removing](#) )

Fit a new O-ring in the specific groove on the seating of the even and odd gear engagement solenoids.

Fit the even and odd gear engagement solenoids in their seatings and tighten the fixing bolts.

Connect the electrical connections of the even and odd gear engagement solenoids.

	Name	Connector
-	Solenoid 1 gear engagement	L51

	Name	Connector
-	Solenoid 2 gear engagement	L52

- [2127C40 hydraulic speed selection hydraulic actuator unit and clutch - r r](#)
- [0010T21 coolant check density and top up if necessary](#)
- [0010T47 hydraulic system fluid for gearbox with hydraulic selection check level and top up if necessary](#)
- [0010T48 hydraulic system for gearbox with hydraulic selection bleed air](#)
- [5530B52 Battery DRIP TRAY/SUPPORT - R.R.](#)

- [5530B56 BATTERY DRIP TRAY COVER - R.R.](#)

- [5530B10 battery - r+r](#)

Connect the Examiner diagnostic instrument and initialise the gear engagement/selection positions, checking that the engagement travel is correct.